

VISTA ASSONOMETRICA
DEL
PEZZO FINITO

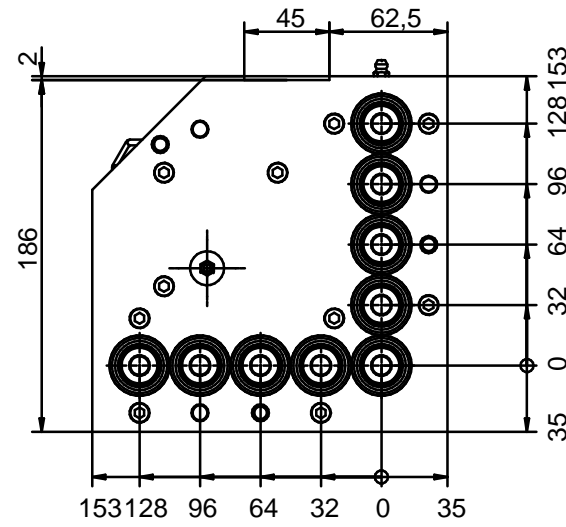

DATI TECNICI TESTA A FORARE A MANDRINI INDIPENDENTI

	ITA	ENG								
Dati generici testa	Nome testa	Bhoring unit name	AXIS 09 CB							
Generic	Peso	Weight	28 Kg							
bhoring unit	Attacco utensili	Tools coupling	Ø 10							
data	Lubrificazione ingranaggi	Lubrication gear	ISOFLEX TOPAS NB52							
	Lubrificazione cilindro	Lubrication cylinder	EMAX COMPLEX 150							
	Pressione di esercizio	Supply pressure	6 bar							
	Pressione Massima	Max pressure	10 bar							
Configurazione	N° Mandrini Vert. Tot	N° Vertical Spindles Tot	9							
Configuration	N° Mandrini Vert. - X	N° Vertical Spindles - X	5							
	N° Mandrini Vert. - Y	N° Vertical Spindles - Y	4							
	N° Testine Orizz. Tot	N° Horizontal Spindles Tot	0							
	N° Gruppi Lama Ø 120	N° Blade Spindles Ø 120	0							
	N° Opz Testine Orizz.	N° Opt. Horizontal Spindles	0							
	N° Opz. Gruppi Lama Ø 120	N° Opt. Blade Spindles Ø 120	0							
			Corsa Stroke (mm)	Spinta Thrust 6 bar (N)	Spinta Thrust 10 bar (N)	Velocità Speed (RPM)				
						50 Hz	60 Hz	Inverter 87 Hz		
Dati utensili	Mandrini Vert.	Vertical Spindles	70	352	628	3093	3712	5625		
Tool data	Testine Orizz.	Horizontal Spindles	70	704	1256	3093	3712	5625		
	Gruppi Lama Ø 120	Blade Spindles Ø 120	70	704	1256	3977	4773	7232		
Dati motore	Frequenza	Frequency				50 Hz	60 Hz	Inverter 87 Hz		
Motor data	Collegamento motore	Motor Connection				Δ	Y	Δ		
	Frequenza nominale	Rated frequency				50 Hz				
	Potenza nominale	Rated power				1.5	1.8	2.6		
	Tensione nominale	Rated voltage				220	380	255	440	400
	Corrente nominale	Rated current				6.1	3.5	6.6	3.8	10.56
	Cos φ	Cos φ				0.84	0.84	-		
	Velocità	Speed				2750	3300	5000		
	Senso di rotaz					Orario (Dx) - Clockwise (Rh)				

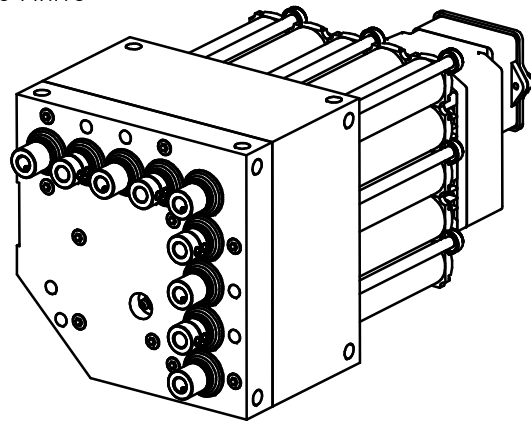
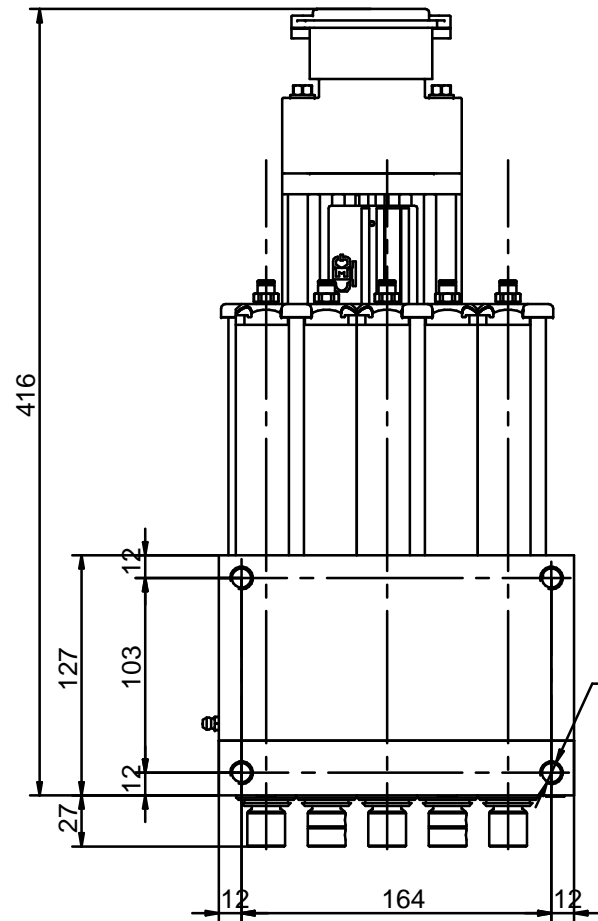

M12 N° 4 FORI
Prof. 15 15

DETTAGLIO A

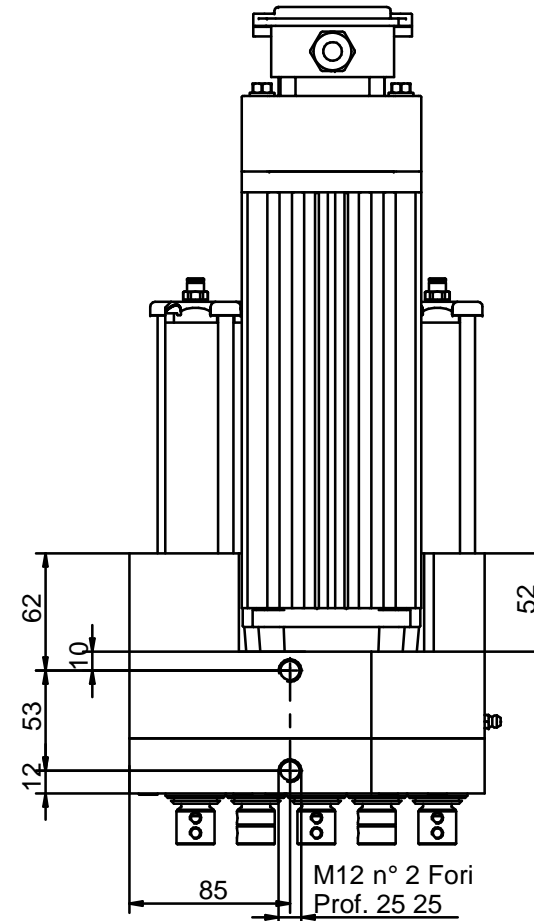
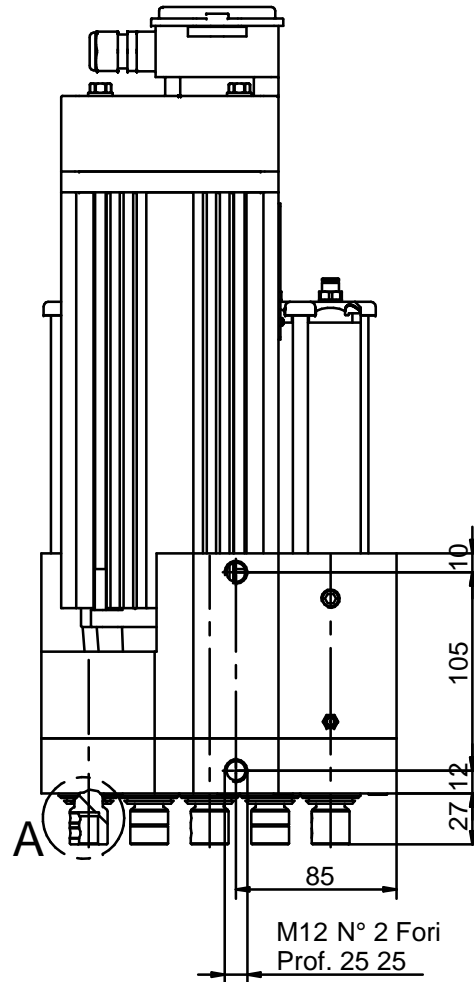
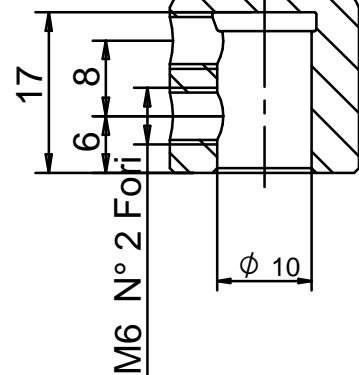

M12 N° 4 FORI
Prof. 15 15

